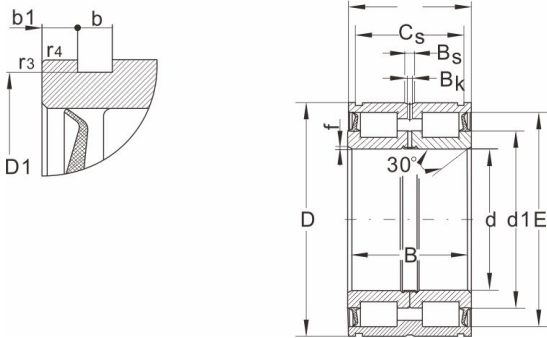

NNF5032.2LS.V**Dimensions and Parameters**

Bearing No.	NNF5032.2LS.V
-------------	---------------

Boundary dimensions [mm]

d	160
D	240
B	109
C	108
CS	95.2
r3,r4 Min	0.6

Basic load ratings (kN)

Dynamic (Cr)	721
Static (Cor)	1410
Limiting speed (rpm)	500

Bearing dimensions

d1	191
D1	236
b	5.2
b1	6.4
Bs	7
Bk	4
f	2
C1 ¹⁾ +0.1	89
C2 ²⁾ +0.1	85

Stop ring

WRE	WRE240
to DIN 471	240×5
Weight	16.5