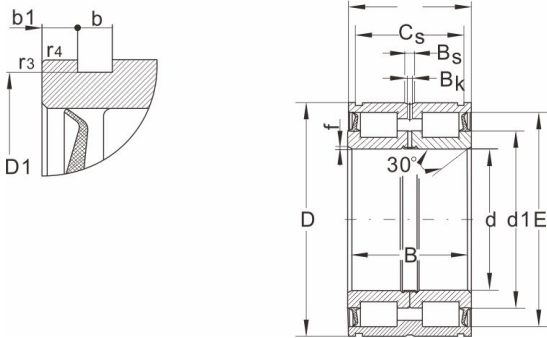

NNF5030.2LS.V**Dimensions and Parameters**

Bearing No.	NNF5030.2LS.V
-------------	---------------

Boundary dimensions [mm]

d	150
D	225
B	100
C	99
CS	87.2
r3,r4 Min	0.6

Basic load ratings (kN)

Dynamic (Cr)	693
Static (Cor)	1310
Limiting speed (rpm)	560

Bearing dimensions

d1	177
D1	221
b	5.2
b1	5.9
Bs	7
Bk	4
f	2
C1 ¹⁾ +0.1	81
C2 ²⁾ +0.1	77

Stop ring

WRE	WRE225
to DIN 471	225×5
Weight	13.5