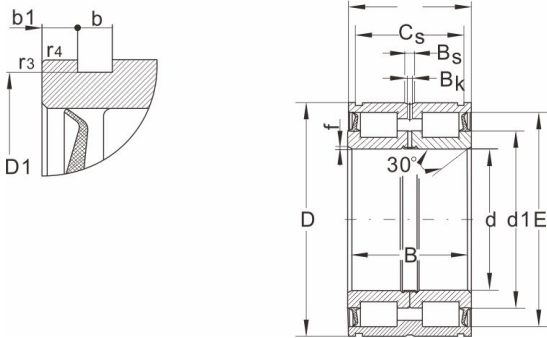

**NNF5022.2LS.V****Dimensions and Parameters**

Bearing No.	NNF5022.2LS.V
-------------	---------------

## Boundary dimensions [mm]

d	110
D	170
B	80
C	79
CS	70.2
r3,r4 Min	0.6

## Basic load ratings (kN)

Dynamic (Cr)	380
Static (Cor)	699
Limiting speed (rpm)	750

## Bearing dimensions

d1	132
D1	167
b	4.2
b1	4.4
Bs	6
Bk	3.5
f	1.8
C1 <sup>1)</sup> +0.1	65
C2 <sup>2)</sup> +0.1	62

## Stop ring

WRE	WRE170
to DIN 471	170×4
Weight	6.45