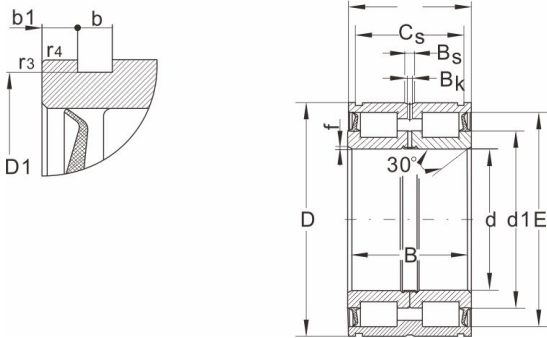

**NNF300.2LS.V****Dimensions and Parameters**

Bearing No.	NNF300.2LS.V
-------------	--------------

## Boundary dimensions [mm]

d	300
D	380
B	95
C	94
CS	83.2
r3,r4 Min	1

## Basic load ratings (kN)

Dynamic (Cr)	900
Static (Cor)	2250
Limiting speed (rpm)	380

## Bearing dimensions

d1	328
D1	374
b	6.3
b1	5.4
Bs	--
Bk	--
f	3
C1 <sup>1)</sup> +0.1	75
C2 <sup>2)</sup> +0.1	71

## Stop ring

WRE	WRE380
to DIN 471	380×6
Weight	25.5